



## T2-C Specifications

### Operation

<b>Ink Type</b>	 High Performance water-based dye ink Four 2-liter tanks CMYK
<b>Print Resolution</b>	1600 x 1600 dpi or 1600 x 800 dpi
<b>Print Speed</b>	6 ips (152 mm/sec) or 12 ips (300 mm/sec)
<b>Print Area</b>	Width: 8.8" (223 mm) Length without stitching: 0.6" – 30" (15 mm – 762 mm) Length with stitching: Unlimited
<b>Media Sensors</b>	Adjustable Optical Tracking Edge Sensor supporting Gap, Reflective mark and Continuous media
<b>Connectivity</b>	Ethernet 10/100/1000
<b>Driver</b>	Microsoft® Windows 10, 8, 7, Windows Server® 2012, 2008, 64/32-bit drivers
<b>Software</b>	TrojanControl Software, Microsoft Windows® 10, 8, 7; Windows Server® 2012, 2008, 64/32-bit Drivers
<b>RIP Software</b>	Trojan RIP or Wasatch SoftRIP software option available
<b>Slitting Station</b>	(3) slitter blades included by default, up to (7) slitter blades may be installed and used. Slitting not allowed for continuous material. Cardboard cores with measuring (label width + edge trim) should be ordered.

### Supplies

<b>Ink Type</b>	 Natura™ ink, high durability, extreme water fastness and good UV light resistance, food-safe ink.
<b>Label Width</b>	1.9" – 9.8" (50 mm – 250 mm)
<b>Length (Die-cut)</b>	0.6" – 60" (15 mm – 762 mm)
<b>Thickness</b>	4 pt/mil – 12 pt/mil
<b>Roll Size</b>	Core: 3" (76 mm) Max. OD: 11.8" (299.7 mm)
<b>Types</b>	Inkjet Coated Tags, Paper, PP, PE, PET in matte, satin or gloss finish

### Maintenance

<b>Maintenance Cartridge</b>	Maintenance tray with replaceable modules (wiper roller/print head cap)
<b>Aerosol Extraction System</b>	Replaceable filters

### Warranty

One-Year Manufacturer's Parts & Labor Warranty (excludes wear parts and supplies)

### Environment & Physical

<b>Operation</b>	Between 68° F – 86° F ( between 20° C – 30° C) at RH 22 to 80% (non-condensing)
<b>Storage</b>	Between 41° F – 122° F (5° C – 50° C) at RH up to 85%, non-condensing at 149° F (65° C)
<b>Power Requirements</b>	100-240V AC 50-60 Hz, 2.5A
<b>Dimensions</b>	With 2 Liter external ink tanks: 23.8" L x 22.8" W x 31.3" H (606 mm x 580 mm x 795 mm )
<b>Touchscreen</b>	7" (177.8 mm) Touchscreen Display
<b>Weight</b>	132.3 lbs. (60 kg) without supplies



*The Labels You Want When You Need Them.®*

CONTACT US TODAY

+49 (0) 6074 31025-00 | [infoDE@astronovaproductid.com](mailto:infoDE@astronovaproductid.com) | [astronovaproductid.com](http://astronovaproductid.com)

 TrojanLabel®

# T2-C



The TrojanLabel® T2-C is a one-of-a-kind tabletop label printing press that incorporates the features and functionality of a traditional large production press into a footprint small enough to fit into any size print department. The T2-C is designed for consistent, high-volume 24/7 production. Accurate image placement, tension control, superior print resolution, built-in-slitters, and reduced total cost of ownership, are just some of the key features that make the T2-C so unique.

A perfect combination of ease-of-use, precision, and quality make the T2-C an ideal label printing solution designed to give both owners and users peace of mind.

# BUILT ON ABILITY

Flexibility, Durability, Reliability

Introducing the **T2-C**, a one-of-a-kind 24/7 tabletop label production press



## Ink Savings

Large 2-liter ink tanks are economical and long-lasting.

## Consistent Print Quality

Servo driven dynamic web tension control for perfect image placement and edge to edge printing. Superior mid-job maintenance routines and aerosol extraction system makes longer print cycles operator friendly.



## In-Line Production

Optional output nip accessory enables inline integration to third-party devices such as converting or packaging equipment. Built-in I/O controls to start, stop or pause the printer for synchronization with downstream processes.



## TrojanControl Software

Full local control plus built-in cost calculator for easy job pricing and analysis.



## Pre-Die Cut Labels

TrojanControl precision makes it effortless to print on pre-die cut labels in perfect registration.

## Flexible Packaging

Food-safe low migration inks for use on flexible packaging material with a variety of barrier options.



## In-line Slitters

Increased throughput with built-in slitter feature allows to slit multiple across label constructions to individual finished rolls while you print. Produce up to 8 separate printed output rolls from a single input roll.

## Remote Diagnostics

Built-in capability allows a tech support professional to access your printer remotely for online remote diagnostics to minimize downtime and continue production.

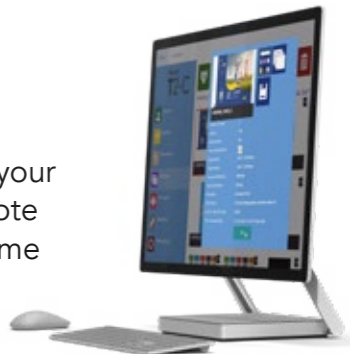

## User-Friendly

Intuitive interface and built-in job library allow for easy operation. Statistics show complete history of print jobs along with job cost information.

